

Through hole tap (inch type)

TH-1.6 series

- A chip mounter can be used for this spacer.
- A spacer can be fit on a PC board just by automatically loading it on the PC board and carrying out with reflow.
- It can be fit from the part face, soldering face and both sides.
- Tape-and-reel has an adsorption film. Please remove by pushing it from the oppo site side after reflow.
- The jig for removing adsorption films (Part No.: TH-JIG) is available.
- Material: Brass
- Finish: Tin plating over nickel base
- Rated current:
 - TH-1.6-□ -2-5620A
 - TH-1.6-□ -4-4030A
 - TH-1.6-□ -6-3240A
- Tightening torque:
 - TH-1.6-□ -2-56.....3kgf-cm (29.4N-cm) or less
 - TH-1.6-□ -4-40.....5kgf-cm (49N-cm) or less(X-direction)
3kgf-cm (29.4N-cm) or less(Y-direction)
 - TH-1.6-□ -6-32.....8kgf-cm (78.4N-cm) or less
- Adaptive printed board thickness: t1.6 or over
(There is no problem if it is used for other board thickness.)
- Please use the automatic mounter of automatic recognition type.



Dimension

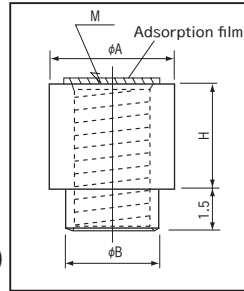

Example of usage

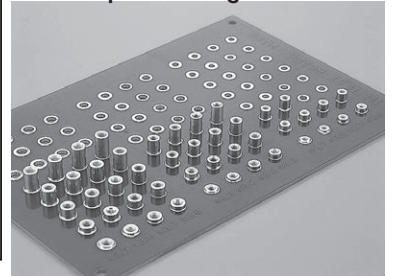

With the adsorption film removed after reflow

Part No.

Part No.	A	B	H	M	quantity per reel
TH-1.6-0.5-2-56	4.5	3.1	0.5	2-56	450 pcs
TH-1.6-1.0-2-56	4.5	3.1	1.0	2-56	450 pcs
TH-1.6-1.5-2-56	4.5	3.1	1.5	2-56	450 pcs
TH-1.6-2.0-2-56	4.5	3.1	2.0	2-56	450 pcs
TH-1.6-2.5-2-56	4.5	3.1	2.5	2-56	350 pcs
TH-1.6-3.0-2-56	4.5	3.1	3.0	2-56	350 pcs
TH-1.6-3.5-2-56	4.5	3.1	3.5	2-56	350 pcs
TH-1.6-4.0-2-56	4.5	3.1	4.0	2-56	250 pcs
TH-1.6-4.5-2-56	4.5	3.1	4.5	2-56	250 pcs
TH-1.6-5.0-2-56	4.5	3.1	5.0	2-56	250 pcs
TH-1.6-5.5-2-56	4.5	3.1	5.5	2-56	350 pcs
TH-1.6-6.0-2-56	4.5	3.1	6.0	2-56	350 pcs
TH-1.6-6.5-2-56	4.5	3.1	6.5	2-56	300 pcs
TH-1.6-7.0-2-56	4.5	3.1	7.0	2-56	300 pcs
TH-1.6-7.5-2-56	4.5	3.1	7.5	2-56	300 pcs
TH-1.6-8.0-2-56	4.5	3.1	8.0	2-56	300 pcs
TH-1.6-8.5-2-56	4.5	3.1	8.5	2-56	250 pcs
TH-1.6-9.0-2-56	4.5	3.1	9.0	2-56	250 pcs
TH-1.6-9.5-2-56	4.5	3.1	9.5	2-56	250 pcs
TH-1.6-10-2-56	4.5	3.1	10	2-56	250 pcs
TH-1.6-0.5-4-40	5.0	3.5	0.5	4-40	450 pcs
TH-1.6-1.0-4-40	5.0	3.5	1.0	4-40	450 pcs
TH-1.6-1.5-4-40	5.0	3.5	1.5	4-40	450 pcs
TH-1.6-2.0-4-40	5.0	3.5	2.0	4-40	450 pcs
TH-1.6-2.5-4-40	5.0	3.5	2.5	4-40	350 pcs
TH-1.6-3.0-4-40	5.0	3.5	3.0	4-40	350 pcs
TH-1.6-3.5-4-40	5.0	3.5	3.5	4-40	350 pcs
TH-1.6-4.0-4-40	5.0	3.5	4.0	4-40	250 pcs
TH-1.6-4.5-4-40	5.0	3.5	4.5	4-40	250 pcs
TH-1.6-5.0-4-40	5.0	3.5	5.0	4-40	250 pcs
TH-1.6-5.5-4-40	5.0	3.5	5.5	4-40	350 pcs
TH-1.6-6.0-4-40	5.0	3.5	6.0	4-40	350 pcs
TH-1.6-6.5-4-40	5.0	3.5	6.5	4-40	300 pcs
TH-1.6-7.0-4-40	5.0	3.5	7.0	4-40	300 pcs
TH-1.6-7.5-4-40	5.0	3.5	7.5	4-40	300 pcs
TH-1.6-8.0-4-40	5.0	3.5	8.0	4-40	300 pcs
TH-1.6-8.5-4-40	5.0	3.5	8.5	4-40	250 pcs
TH-1.6-9.0-4-40	5.0	3.5	9.0	4-40	250 pcs
TH-1.6-9.5-4-40	5.0	3.5	9.5	4-40	250 pcs
TH-1.6-10-4-40	5.0	3.5	10	4-40	250 pcs

Part No.	A	B	H	M	quantity per reel
TH-1.6-2.0-6-32	7.0	5.5	2.0	6-32	250 pcs
TH-1.6-2.5-6-32	7.0	5.5	2.5	6-32	200 pcs
TH-1.6-3.0-6-32	7.0	5.5	3.0	6-32	200 pcs
TH-1.6-3.5-6-32	7.0	5.5	3.5	6-32	450 pcs
TH-1.6-4.0-6-32	7.0	5.5	4.0	6-32	450 pcs
TH-1.6-4.5-6-32	7.0	5.5	4.5	6-32	300 pcs
TH-1.6-5.0-6-32	7.0	5.5	5.0	6-32	300 pcs
TH-1.6-5.5-6-32	7.0	5.5	5.5	6-32	250 pcs
TH-1.6-6.0-6-32	7.0	5.5	6.0	6-32	250 pcs
TH-1.6-6.5-6-32	7.0	5.5	6.5	6-32	200 pcs
TH-1.6-7.0-6-32	7.0	5.5	7.0	6-32	200 pcs
TH-1.6-7.5-6-32	7.0	5.5	7.5	6-32	200 pcs
TH-1.6-8.0-6-32	7.0	5.5	8.0	6-32	200 pcs
TH-1.6-8.5-6-32	7.0	5.5	8.5	6-32	200 pcs
TH-1.6-9.0-6-32	7.0	5.5	9.0	6-32	200 pcs
TH-1.6-9.5-6-32	7.0	5.5	9.5	6-32	150 pcs
TH-1.6-10-6-32	7.0	5.5	10.0	6-32	150 pcs

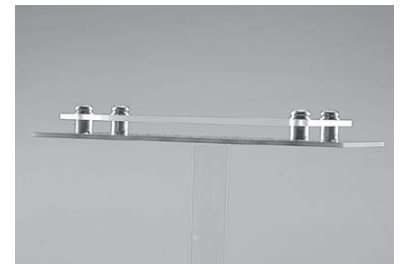

Condition of fitting the panel to the printed board

When it is fit to the PC board

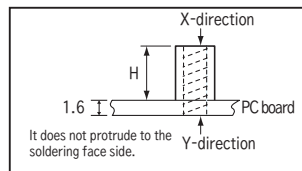

- No2-56 P = 0.4536
- No4-40 P = 0.6350
- No6-32 P = 0.7938

To order bulk product

TH-1.6-0.5-4-40-B

Please specify -B.

- 100 pieces are included in 1 pack.
- Adsorption films are not put on the bulk products.

▲ Use of a through hole tap is limited to a through hole board.
(It is impossible to use it for a one-sided board and non through hole board.)

Through hole tap (inch type)

TH-1.6 series

■ Recommended land information

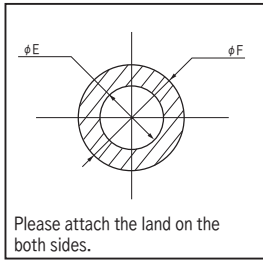

■ Recommended metal mask
(Recommended metal mask thickness: 150 μm to 200 μm)

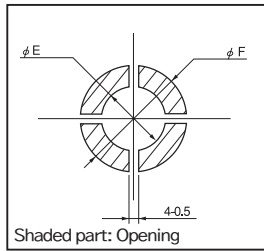

Part No.	E	F
TH-1.6-□-2-56	3.3	5.5
TH-1.6-□-4-40	3.7	6.0
TH-1.6-□-6-32	5.7	8.0

· If it is bigger than the recommended fitting through hole (φ E), the torque to the Y-direction (soldering face side) will be decreased. (As the flow of soldering to the through hole is reduced)

■ Dimension of the reel

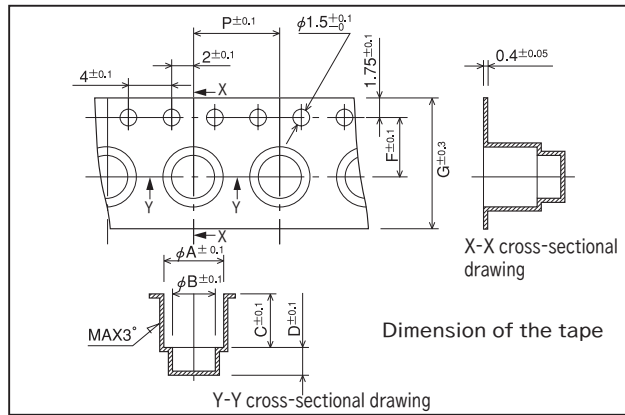
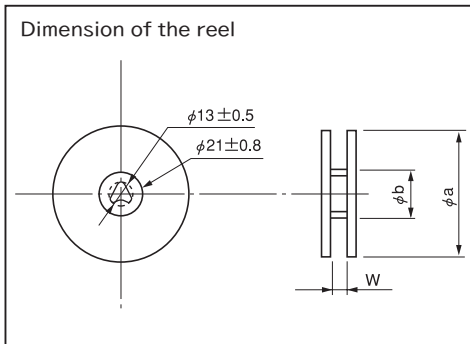

■ Part No.

Part No.	Reel			Tape							
	a	b	W	A	B	C	D	F	G	P	
TH-1.6-0.5-2-56	180	60	13	4.8	3.4	1.3	1.7	5.5	12	8	
TH-1.6-1.0-2-56	180	60	13	4.8	3.4	1.5	1.7	5.5	12	8	
TH-1.6-1.5-2-56	180	60	13	4.8	3.4	2.3	1.7	5.5	12	8	
TH-1.6-2.0-2-56	180	60	13	4.8	3.4	2.3	1.7	5.5	12	8	
TH-1.6-2.5-2-56	180	60	13	4.8	3.4	3.8	1.7	5.5	12	8	
TH-1.6-3.0-2-56	180	60	13	4.8	3.4	3.8	1.7	5.5	12	8	
TH-1.6-3.5-2-56	180	60	13	4.8	3.4	3.8	1.7	5.5	12	8	
TH-1.6-4.0-2-56	180	60	13	4.8	3.4	5.0	1.7	5.5	12	8	
TH-1.6-4.5-2-56	180	60	13	4.8	3.4	5.0	1.7	5.5	12	8	
TH-1.6-5.0-2-56	180	60	13	4.8	3.4	5.0	1.7	5.5	12	8	
TH-1.6-5.5-2-56	254	80	17.5	4.8	0	7.8	0	7.5	16	12	
TH-1.6-6.0-2-56	254	80	17.5	4.8	0	7.8	0	7.5	16	12	
TH-1.6-6.5-2-56	254	80	17.5	4.8	0	8.8	0	7.5	16	12	
TH-1.6-7.0-2-56	254	80	17.5	4.8	0	8.8	0	7.5	16	12	
TH-1.6-7.5-2-56	254	80	17.5	4.8	0	9.8	0	7.5	16	12	
TH-1.6-8.0-2-56	254	80	17.5	4.8	0	9.8	0	7.5	16	12	
TH-1.6-8.5-2-56	254	80	17.5	4.8	0	10.8	0	7.5	16	12	
TH-1.6-9.0-2-56	254	80	17.5	4.8	0	10.8	0	7.5	16	12	
TH-1.6-9.5-2-56	254	80	17.5	4.8	0	11.8	0	7.5	16	12	
TH-1.6-10-2-56	254	80	17.5	4.8	0	11.8	0	7.5	16	12	
TH-1.6-0.5-4-40	180	60	13	5.3	3.8	1.5	1.7	5.5	12	8	
TH-1.6-1.0-4-40	180	60	13	5.3	3.8	1.5	1.7	5.5	12	8	
TH-1.6-1.5-4-40	180	60	13	5.3	3.8	2.3	1.7	5.5	12	8	
TH-1.6-2.0-4-40	180	60	13	5.3	3.8	2.3	1.7	5.5	12	8	
TH-1.6-2.5-4-40	180	60	13	5.3	3.8	3.8	1.7	5.5	12	8	
TH-1.6-3.0-4-40	180	60	13	5.3	3.8	3.8	1.7	5.5	12	8	
TH-1.6-3.5-4-40	180	60	13	5.3	3.8	3.8	1.7	5.5	12	8	
TH-1.6-4.0-4-40	180	60	13	5.3	3.8	5.3	1.7	5.5	12	8	
TH-1.6-4.5-4-40	180	60	13	5.3	3.8	5.3	1.7	5.5	12	8	

Part No.	Reel			Tape							
	a	b	W	A	B	C	D	F	G	P	
TH-1.6-5.0-4-40	180	60	13	5.3	3.8	1.5	1.7	5.5	12	8	
TH-1.6-5.5-4-40	254	80	17.5	5.3	0	7.8	0	7.5	16	12	
TH-1.6-6.0-4-40	254	80	17.5	5.3	0	7.8	0	7.5	16	12	
TH-1.6-6.5-4-40	254	80	17.5	5.3	0	8.8	0	7.5	16	12	
TH-1.6-7.0-4-40	254	80	17.5	5.3	0	8.8	0	7.5	16	12	
TH-1.6-7.5-4-40	254	80	17.5	5.3	0	9.8	0	7.5	16	12	
TH-1.6-8.0-4-40	254	80	17.5	5.3	0	9.8	0	7.5	16	12	
TH-1.6-8.5-4-40	254	80	17.5	5.3	0	10.8	0	7.5	16	12	
TH-1.6-9.0-4-40	254	80	17.5	5.3	0	10.8	0	7.5	16	12	
TH-1.6-9.5-4-40	254	80	17.5	5.3	0	11.8	0	7.5	16	12	
TH-1.6-10-4-40	254	80	17.5	5.3	0	11.8	0	7.5	16	12	
TH-1.6-2.0-6-32	180	80	17.5	7.3	0	4.0	0	7.5	16	12	
TH-1.6-2.5-6-32	180	80	17.5	7.3	0	5.0	0	7.5	16	12	
TH-1.6-3.0-6-32	180	80	17.5	7.3	0	5.0	0	7.5	16	12	
TH-1.6-3.5-6-32	254	80	17.5	7.3	0	6.0	0	7.5	16	12	
TH-1.6-4.0-6-32	254	80	17.5	7.3	0	6.0	0	7.5	16	12	
TH-1.6-4.5-6-32	254	80	17.5	7.3	0	7.0	0	7.5	16	12	
TH-1.6-5.0-6-32	254	80	17.5	7.3	0	7.0	0	7.5	16	12	
TH-1.6-5.5-6-32	254	80	25.5	7.3	0	8.0	0	11.5	24	16	
TH-1.6-6.0-6-32	254	80	25.5	7.3	0	8.0	0	11.5	24	16	
TH-1.6-6.5-6-32	254	80	25.5	7.3	0	9.0	0	11.5	24	16	
TH-1.6-7.0-6-32	254	80	25.5	7.3	0	9.0	0	11.5	24	16	
TH-1.6-7.5-6-32	254	80	25.5	7.3	0	10	0	11.5	24	16	
TH-1.6-8.0-6-32	254	80	25.5	7.3	0	10	0	11.5	24	16	
TH-1.6-8.5-6-32	254	80	25.5	7.3	0	11	0	11.5	24	16	
TH-1.6-9.0-6-32	254	80	25.5	7.3	0	11	0	11.5	24	16	
TH-1.6-9.5-6-32	254	80	25.5	7.3	0	11.8	0	11.5	24	16	
TH-1.6-10-6-32	254	80	25.5	7.3	0	11.8	0	11.5	24	16	