

Spring probe [VP series] (10pcs/pack)

- This pin is pulled in / out by a spring.
- This is used for checking PC boards, checking after mounting, etc.
- Please put this in a socket and use.

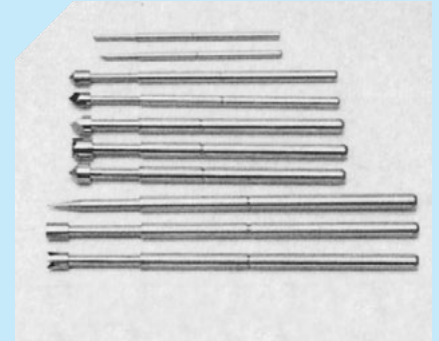
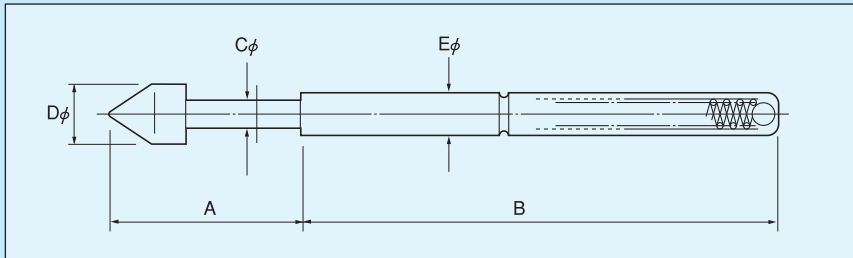

Part number	A	B	C	D	E	Edge shape	Spring pressure (g) (with 2/3 stroke)	Stroke	Adaptive socket
VP-1-1	6.2	18.5	1.0	1.8	1.36	A	100	4.2	VS-1-1
VP-1-2	6.2	18.5	1.0	1.8	1.36	F	100	4.2	VS-1-1
VP-1-3	8.6	24.5	1.0	1.0	1.37	C	180	6.0	VS-1-2
VP-1-4	8.4	24.5	1.0	1.5	1.37	D	180	6.0	VS-1-2
VP-1-6	6.2	18.5	1.0	1.8	1.36	B	100	4.2	VS-1-1
VP-1-7	8.4	24.5	1.0	1.5	1.37	H	180	6.0	VS-1-2
VP-2-1	6.2	18.5	0.8	1.5	1.0	A	100	4.2	VS-2-1
VP-2-2	6.2	18.5	0.8	1.5	1.0	F	100	4.2	VS-2-1
VP-2-3	6.0	18.3	0.7	0.7	1.0	C	70	4.3	VS-2-1
VP-2-4	6.3	18.3	0.7	1.3	1.0	B	70	4.3	VS-2-1
VP-2-5	6.3	18.3	0.7	0.7	1.0	H	70	4.3	VS-2-1
VP-3-1	4.0	13.0	0.5	0.5	0.68	G	85	2.8	VS-3-1
VP-3-2	4.0	13.0	0.5	0.5	0.68	C	80	2.3	VS-3-1
VP-3-3	4.0	13.0	0.5	0.5	0.68	D	85	2.8	VS-3-1
VP-3-4	4.0	13.0	0.5	0.5	0.68	H	85	2.8	VS-3-1
VP-3-5	4.8	13.0	0.5	1.0	0.68	F	95	2.8	VS-3-1

■ Edge shape

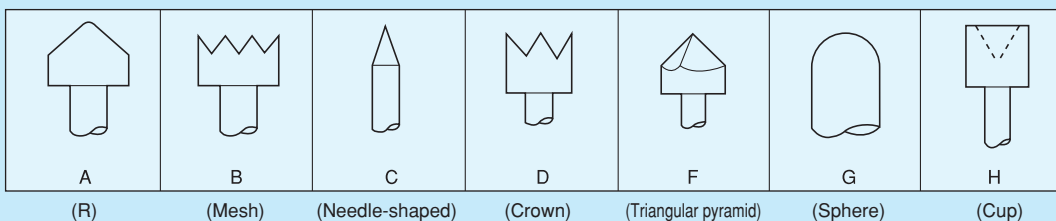

■ Specification

- Electrical specifications
 - Rated current: 3A
 - Resistance value: 50mΩ or less
 - Material and surface finish
 - Edge part: Beryllium copper, SK, Phosphor bronze (rhodium plating)
 - Case part: Phosphor bronze, Nickel silver (gold plating)
 - Spring part: Piano wire (gold plating), Stainless steel
- * Please note that this is subject to change for improving the quality.