

Check terminal for logic [SA series] (1000pcs/pack)

- This is a check terminal to be used for a PC board with a thickness of 1.0t, 0.8t.
- Material: Brass
- Finish: Gold plating over nickel base

Table of dimensions

Part number	H	Printed board fitting hole diameter
SA-1-1	3.0	0.8 φ
SA-1-2	5.0	0.8

For printed board with a thickness of 1.0t, 0.8t

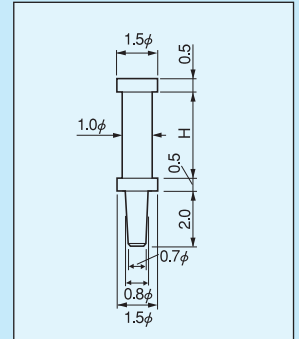
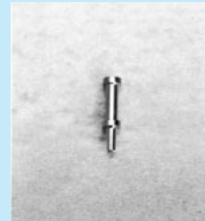

For check

Check terminal for logic [SE series] (1000pcs/pack)

- This is a check terminal to be used for a PC board with a thickness of 0.6t or less.
- Please use this terminal for a ceramic board, flexible board, etc.
- Material: Brass
- Finish: Gold plating over nickel base

Table of dimensions

Part number	A	B	C	D	Printed board fitting hole diameter
SE-1-1	1.0	0.7	1.0	0.48	0.5 φ
SE-1-2	1.0	0.7	1.5	0.48	0.5
SE-1-3	1.0	0.7	2.0	0.48	0.5
SE-2-1	1.5	1.0	1.0	0.78	0.8
SE-2-2	1.5	1.0	1.5	0.78	0.8
SE-2-3	1.5	1.0	2.0	0.78	0.8
SE-2-4	1.5	1.0	3.0	0.78	0.8

For printed board with a thickness of 0.6t or less

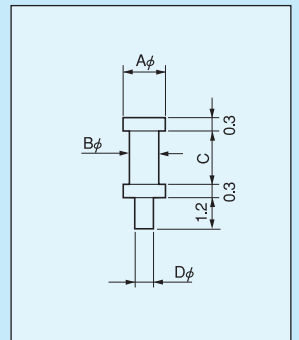

Long check terminal [CT-8 series] (100pcs/pack)

- Please use this terminal when a long part is installed nearby.
- In addition to using it for check, you can fit a part on the terminal.
- Material: Brass
- Finish: Gold plating over nickel base
- Recommended fitting hole: TH: φ 1.6 Land: φ 4

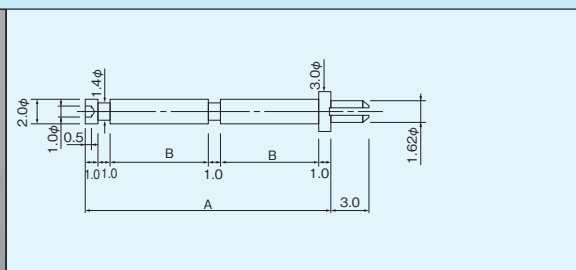

Part number	A	B
CT-8-20	20	8
CT-8-25	25	10.5

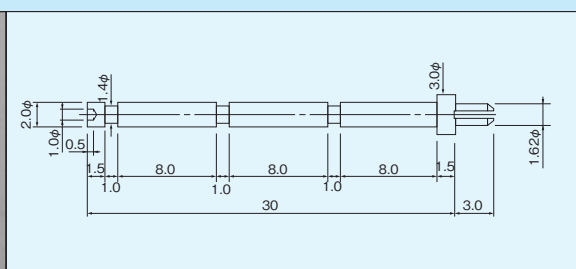

Part number
CT-8-30