

Micro Connector

- Although connectors on a PC board are conventionally gathered at one place and taken out to the outside, high-density mounting and reduction in size are adopted recently and it becomes difficult to gather signal lines at one place due to the pattern design.
- By using this micro connector, they can be separately taken out to the outside.
- As this connector is of super-small type, it can be used in a limited space.
- The housing for 2.54-mm pitch is also available.

Combination

Male side (electric wire fitting side)

Female side (PC board side) (This is adaptive for other types.)

Pin	Housing	Part number	Printed board fitting hole diameter (ϕ)	Height above the printed board part surface: A mm	Height above the housing + female pin part surface: B mm
OM-1 Plus	OH-number of pins Number of pins (1P to 20P)	PD- 1	0.6	4.2	8.7
		PD-10	0.6	4.2	8.7
		PD- 4	1.4	0.8	5.3
		PM- 1	0.6	4.2	8.7
		PM-10	0.6	4.2	8.7
		PM- 5	0.6	2.5	2.5
OM-2 Plus	OH-number of pins Number of pins (1P to 20P)	PD- 7	1.0	0.4	4.9
OM-3 Plus	OH-number of pins Number of pins (1P to 20P)	PC-10	1.0	0.5	5.0

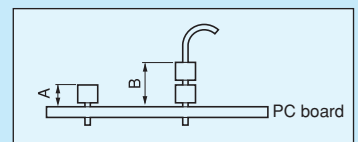

Male pin [OM series] (100pcs/pack)

- This product and the housing (OH series) are set as a pair.
- This product can be used alone (without housing).
- Please press-fit by using OM series press-fitting tool (OMXT-1).

Part number	A (mm)	L (mm)	B (ϕ)	Adaptive female pin
OM-1	3.7	8.2	0.55	PD, PM series
OM-2	3.0	7.5	0.48	PD-7
OM-3	3.6	8.1	0.50	PC-10

- Material: Brass
- Finish: Gold plating over nickel base
- Electric capacity: 1A
- Mountable electric wire diameter: Thinner than AWG26
- Mounting housing: OH series

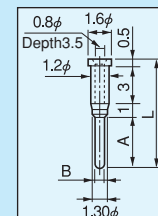

OM-1 OM-2

Micro connector

Housing [OH series] (100pcs/pack)

- This housing is used for fixing OM-1, OM-2 and OM-3.
- The tool for press-fitting to the housing is OMXT-2 and OMXT-3.

Specification

Material	PBT resin (UL94V-0)
Color	Black
Temperature range	-40 to +125°C
Number of pins	Max. 20P
No.1 display	White marking

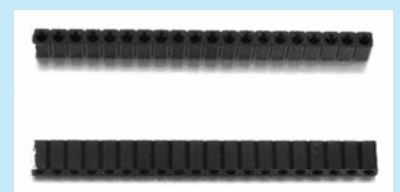
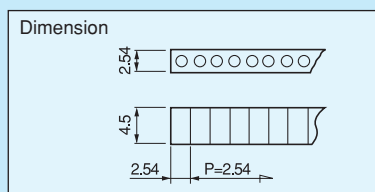

How to order

OH-3

↑ Please fill in the desired number of poles. (Maximum number: 20P)