

Pin for surface mounting [DH, DHS series] (1000pcs/pack)

- This pin can stand on a board for surface mounting.
- DHS series allows positioning.
- Material DH-4~6: Phosphor bronze
DHS-4~6: Phosphor bronze
DH-8~DH-20: Copper
DHS-8~DHS-20: Copper
- Finish: Gold plating over nickel base
- Rated current

- DH-4-□) 2A
- DHS-4-□) 2A
- DH-6-□) 4A
- DHS-6-□) 4A
- DH-8-□) 5A
- DHS-8-□) 5A
- DH-10-□) 10A
- DHS-10-□) 10A
- DH-12-□) 13A
- DHS-12-□) 13A
- DH-14-□) 20A
- DHS-14-□) 20A
- DH-20-□) 30A
- DHS-20-□) 30A

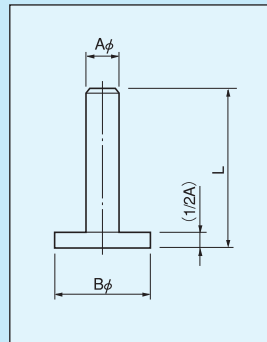

DH series

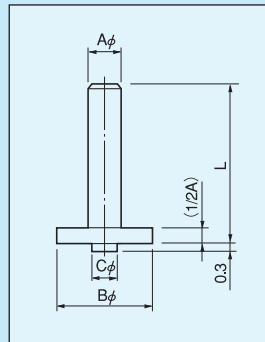

DHS series
(with positioning pin)



Example of usage

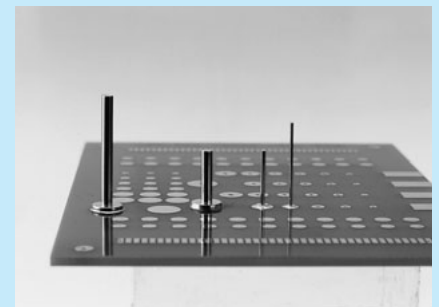

Recommended land diameter

• DH series

	A φ	L
DH- 4	2.0	5
DH- 6	2.5	10
DH- 8	3.0	15
DH-10	3.5	20
DH-12	4.0	20
DH-14	4.5	20
DH-20	6.0	20

• DHS series

	A φ	B φ ^{+0.1 -0}	L
DHS- 4	2.0	0.5	5
DHS- 6	2.5	0.7	10
DHS- 8	3.0	0.7	15
DHS-10	3.5	0.7	20
DHS-12	4.0	0.7	20
DHS-14	4.5	0.9	20
DHS-20	6.0	0.9	20

* Apply the cream solder evenly.

Part number	A	B	L
DH- 4- 5	0.45	1.2	5
DH- 4-10	∕	∕	10
DH- 4-15	∕	∕	15
DH- 4-20	∕	∕	20
DH- 6- 5	0.6	1.8	5
DH- 6-10	∕	∕	10
DH- 6-15	∕	∕	15
DH- 6-20	∕	∕	20
DH- 8- 5	0.8	2.3	5
DH- 8-10	∕	∕	10
DH- 8-15	∕	∕	15
DH- 8-20	∕	∕	20
DH-10- 5	1.0	3.0	5
DH-10-10	∕	∕	10
DH-10-15	∕	∕	15
DH-10-20	∕	∕	20
DH-12- 5	1.2	3.5	5
DH-12-10	∕	∕	10
DH-12-15	∕	∕	15
DH-12-20	∕	∕	20
DH-14- 5	1.4	4.0	5
DH-14-10	∕	∕	10
DH-14-15	∕	∕	15
DH-14-20	∕	∕	20
DH-20- 5	2.0	5.5	5
DH-20-10	∕	∕	10
DH-20-15	∕	∕	15
DH-20-20	∕	∕	20

Part number	A	B	C	L
DHS- 4- 5	0.45	1.2	0.45	5
DHS- 4-10	∕	∕	∕	10
DHS- 4-15	∕	∕	∕	15
DHS- 4-20	∕	∕	∕	20
DHS- 6- 5	0.6	1.8	0.6	5
DHS- 6-10	∕	∕	∕	10
DHS- 6-15	∕	∕	∕	15
DHS- 6-20	∕	∕	∕	20
DHS- 8- 5	0.8	2.3	0.6	5
DHS- 8-10	∕	∕	∕	10
DHS- 8-15	∕	∕	∕	15
DHS- 8-20	∕	∕	∕	20
DHS-10- 5	1.0	3.0	0.6	5
DHS-10-10	∕	∕	∕	10
DHS-10-15	∕	∕	∕	15
DHS-10-20	∕	∕	∕	20
DHS-12- 5	1.2	3.5	0.6	5
DHS-12-10	∕	∕	∕	10
DHS-12-15	∕	∕	∕	15
DHS-12-20	∕	∕	∕	20
DHS-14- 5	1.4	4.0	0.8	5
DHS-14-10	∕	∕	∕	10
DHS-14-15	∕	∕	∕	15
DHS-14-20	∕	∕	∕	20
DHS-20- 5	2.0	5.5	0.8	5
DHS-20-10	∕	∕	∕	10
DHS-20-15	∕	∕	∕	15
DHS-20-20	∕	∕	∕	20

For surface mounting