

**Terminal for hybrid IC [CB-7 series] (1000pcs/reel)**

- This terminal can be fit with a pitch of 2.54 mm to a PC board.
- This is supplied in the reel form with a pitch of 2.54 mm
- Material: Phosphor bronze
- Finish: Tin plating over nickel base

■ Part number CB-7-1

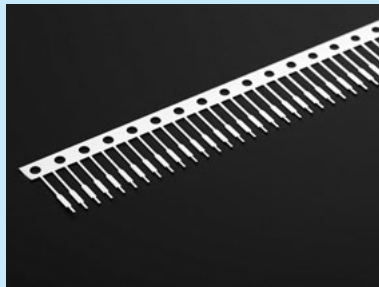
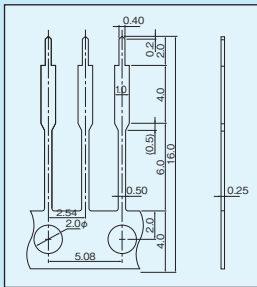

■ Recommended fitting hole:  
Upper side:  $\phi$  TH0.7  
Lower side:  $\phi$  TH0.8

■ Part number CB-7-2

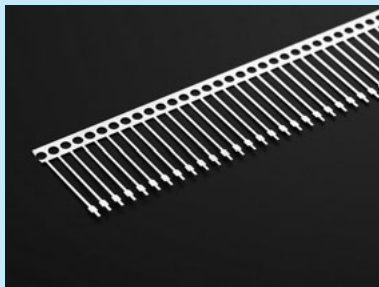
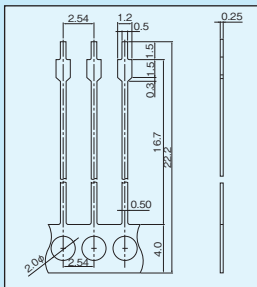

■ Recommended fitting hole:  
TH  $\phi$  0.8

■ Part number CB-7-3

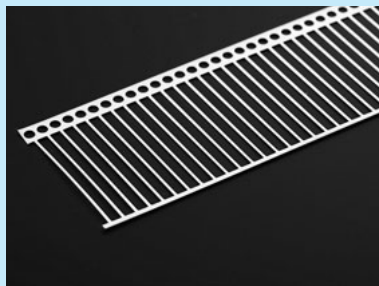
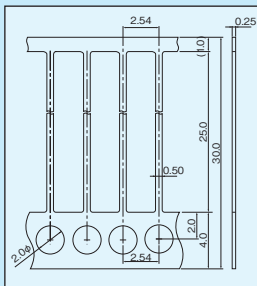

■ Recommended fitting hole:  
TH  $\phi$  0.8

**Jig for fitting the terminal [CBX series] (1pc/pack)**

- This jig is to fix the terminal when fitting CB series to PCB.

■ Part number

CBX-100(for CB-1, CB-3 series)  
CBX-200(for CB-2, CB-4 series)

Example of usage

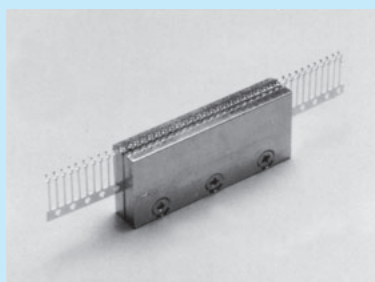
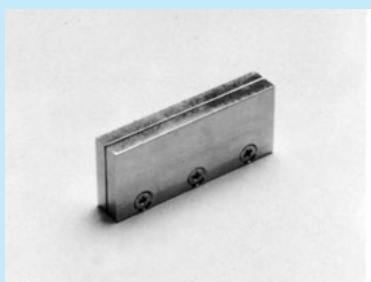

For hybrid IC